

## Part B Application form

# Application for a permit for a timber and manufacture of wood-based products installation

### Local Authority Pollution Prevention and Control Pollution Prevention and Control Act, 1999 Environmental Permitting (England and Wales) Regulations 2016

#### Introduction

#### When to use this form

Use this form if you are applying for a permit to a Local Authority to operate a timber and manufacture of wood-based products installation as defined in Schedule 1 to the Environmental Permitting (England and Wales) Regulations 2016 ("the EP Regulations").

#### Which parts of the form to fill in

You should fill in as much of this form as possible. The appropriate fee must be enclosed with the application to enable it to be processed further. When complete return to:

Shared Regulatory Services  
Bridgend County Borough Council  
Civic Offices  
Angel Street  
Bridgend CF31 4WB

#### Other documents you may need to submit

Each time a request for a document is made in the application form you will need to record a document reference number for the document or documents that you are submitting in the space provided on the form for this purpose. Please also mark the document(s) clearly with this reference number.

#### If you need help and advice

We have made the application form as straightforward as possible, but please get in touch with us at the local authority address given above if you need any advice on how to set out the information we need.

**For the purposes of Section H of the form, a relevant offence is any conviction for an offence relating to the environment or environmental regulation.**

#### LAPPC application form: to be completed by the operator

For Local Authority use		
Application reference	Officer reference	Date received

**A Applicant details**

**A1 Name and address of the installation**

GE Door Manufacturing Ltd

Forge Industrial Estate

Maesteg

**Postcode** CF340AY

**Telephone** 01656 730070

The Ordnance Survey national grid reference *8 characters*,  
for example, SJ 123 456 (can be obtained from typing postcode into one of the on-line mapping sites).

SS	84	83	69	19	88		
----	----	----	----	----	----	--	--

**A2 Existing permits:**

Please give details of any existing LAPPC or LA-IPPC authorisation for the installation, or any waste management licences or water discharge consents, including reference number(s) and type(s):

Nolan Skips EAWML34205

Please provide the information requested below about the "Operator", which means the person who it is proposed will have control over the installation in accordance with the permit (if granted)

**A3 Operator details – Please provide the full name of company, partnership or corporate body-  
The 'operator' = the person who it is proposed will have control over the installation in  
accordance with the permit (if granted).)**

**Name:** G Evans

**Trading/business name (if different)**

GE Door Manufacturing Ltd

**Registered Office address** C/O Clay Shaw Thomas

Bocam Park, Bridgend

**Postcode:** CF35 5LJ

**Principal Office address (if different):** Forge Industrial Estate, Maesteg

**Postcode:** CF34 0AY

**Company registration number** 5760210

**A4 Any holding company?**

Is the operator a subsidiary of a holding company within the meaning of section 1159 of the Companies Act 2006? If "yes" please fill in details of the ultimate holding company.

No ☐ Yes ☒

Name: GE Door Solutions Ltd

Trading name, if different:

Registered office address;  
CST Bocam Park

Principal office address, if different:  
Forge Ind Estate Maesteg

Company registration number:  
4445808

**A5 Who can we contact about your application?** *It will help to have someone who we can contact directly with any questions about your application. The person you name should have the authority to act on behalf of the operator - This can be an agent or consultant.*

Name and position: P Trebble

Telephone: 01656 730070

Email: phil@gecarpentry.co.uk

**B**     **The Installation**

**B1**    **What activities are, or will be, carried on at the installation? Please include "directly associated activities" (this term is explained in Annex III in Part B of the general guidance manual).**

Working, machining and manufacture of wood based products

---

**B2**    **Do you operate a timber process and/or manufacture wood-based products?**

☒ Yes ☐ No

**B3**    **Do you have a combustion process burning waste wood in an appliance greater than 0.4MW?**

☒ Yes ☐ No

**B4**    **Why is the application being made?**

☐ new installation

☒ change to existing installation means it now needs a permit

**B5**    **Site maps – please provide:**

- **A location map with a red line round the boundary of the installation**

Document reference: GE Location Map

- **A site plan or plans showing where all the relevant activities are on site:**

- a) where the processing plant will be installed
- b) the areas and buildings/structures designated for materials/ waste storage and the type of storage
- c) the conveyors and transfer points
- d) any directly associated activities or waste operations.

To save applying for permit variations, you can also show where on site you might want to use for storage etc in the future.

Document reference: GE Door Manufacturing Floor plans 1 & 2

**B6**    **Are there any sites of special scientific interest (SSSIs) or European protected sites nearer than any of the following distances to the proposed installation?**

- 2km where the installation includes Part B combustion

☐ Yes    ☒ No

- ½ km - in all other cases?

☐ Yes    ☒ No

If 'yes', is the installation likely to have a significant effect on these sites and, if so, please write on a separate sheet or enclose a relevant document explaining what the implications are for the purposes of the Conservation (Natural Habitats etc) Regulations 1994 (see appendix 2 of Annex XVII of the general guidance manual)

**B7 Will emissions from the activity potentially have significant environmental effects (including nuisance)?**

☐ Yes ☒ No

**If 'yes': list the potential significant local environmental effects (including nuisance) of the foreseeable emissions**

Document Reference: \_\_\_\_\_

- please enclose a copy of any environmental impact assessment which has been carried out for the installation under planning legislation or for any other purpose.

Document Reference: \_\_\_\_\_

**C     The details**

**C1    Do you have arrestment plant on site?** *[informs conditions 3, 5 & 13]*

☒ Yes ☐ No

**If yes, go to C2. If No, go to C8.**

**C2    If yes, does the arrestment plant use (tick all that apply)**

a) bag filters ☒ Yes ☐ No

b) cyclones ☒ Yes ☐ No

c) other, please specify: \_\_\_\_\_

**C3    If you have bag filters, do you have a filter maintenance programme?**

☒ Yes ☐ No ☐ n/a *[informs condition 3]*

**If you have bag filters, do you replace filter media at least every 4 years?**

☒ Yes ☐ No ☐ n/a *[informs condition 13]*

**C4    Do the continuous monitors have alarms which are: (tick all that apply)**

a) visible ☒

b) audible ☐

c) alarm activation recorded automatically ☐

d) is a trigger level set ☐

**If so, at what percentage of the emission limit is the value set?** \_\_\_\_\_ %

**C5    If you have cyclones, Is the water content >20%, of the solid content by weight, of the wood you process?** *[informs choice of abatement]*

☐ Yes ☒ No ☐ n/a

**C6    If you have cyclones, does the process only produce emissions comprised mainly of large particles?** *[informs choice of abatement]*

☐ Yes ☒ No ☐ n/a

**C7    Does your arrestment plant have automatic shutdown in the event of a blockage?** *[informs conditions 1 & 5]*

☐ Yes ☒ No

**C8 In which of the following will wood dust be stored?**

(tick all that apply)

[informs conditions 4 & 8]

- a) silo ☒
- b) bulk storage tank ☐
- c) in fully-enclosed containers ☐
- d) other - please specify: and dust bags

**C9 How do you transfer wood dust around the site?**

(tick all that apply)

[informs conditions 10, 11 & 12]

- a) using pneumatic transfer ☒
- b) belt conveyors ☐
- c) fully-enclosed transport ☐
- d) sheeted transport ☐
- e) bagged ☒
- f) other - please specify \_\_\_\_\_

**If you use pneumatic transfer, will displaced air be:**

(tick all that apply)

[informs condition 7]

- a) vented to arrestment plant ☒
- b) back-vented to the delivery tanker ☐
- c) other - please specify \_\_\_\_\_

**C10 Which of the following methods will be used to minimise emissions at transfer points, including free fall of material?**

(tick all that apply)

[informs condition 9]

- a) enclosed ☒
- b) enclosed and ducted to arrestment equipment ☒
- c) fitted with a chute ☐
- d) other - please specify \_\_\_\_\_

*Note: dusty material should be taken to be any material which can be wind-entrained. It excludes for example >3mm particles*

**C11 Does loading/unloading of dusty materials:**

[informs condition 5 & 6]

- a) automatically stop for over-filling ☐ Yes ☐ No N/A
- b) automatically stop for over-pressurisation ☐ Yes ☐ No
- c) have alarms to warn of over-filling ☐ Yes ☐ No
- d) have alarms to warn of over-pressurisation ☐ Yes ☐ No

**C12 How will potentially dusty materials (including any raw materials, finished products and waste), arrive at or leave the site?**  
*(tick all that apply)* *[informs condition 12]*

	Raw Materials	Finished Products	Waste
Road	X	X	
Rail			
Other			

**C13 When wood dust is moved offsite, do you fill vehicles directly from the arrestment plant?**  
*[informs condition 5 & 12]*  
☐ Yes ☐ No N/A

**If yes go to C14, If No go to C15**

**C14 Do vehicles have *(tick all that apply)***

- a) side windows ☐
- b) overfilling alarms ☐

**C15 Do you have environmental management procedures and policy?**  
*[informs condition 3, 15 & 16]*  
☒ Yes ☐ No

**D Anything else**

Please tell us anything else you would like us to take account of.

Document Reference \_\_\_\_\_

**E Application fee**

You must enclose the relevant fee with your application.

If your application is successful you will also have to pay an annual subsistence charge, so please say who you want invoices to be sent to.

GE Door Manufacturing Ltd  
Accounts office  
Forge Industrial Estate  
Maesteg  
CF340AY



## H Declarations A and B for signing, please

*These declarations should be signed by the person listed in answer to question A3. Where more than one person is identified as the operator, all should sign. Where a company or other body corporate is the operator, an authorised person should sign and provide evidence of authority from the board.*

### **Declaration A:** I/We certify

**EITHER** – As evidence of my/our competence to operate this installation in accordance with the EP Regulations, no offences have been committed in the previous five years relating to the environment or environmental regulation.

**OR-** The following offences have been committed in the previous five years which may be relevant to my/our competence to operating this installation in accordance with the regulations:

---

---

Signature:  Name: D. Tremble  
Position: Director Date: 23/10/18

**Declaration B:** I/We certify that the information in this application is correct. I/We apply for a permit in respect of the particulars described in this application (including the listed supporting documentation) I/we have supplied. *(Please note that each individual operator must sign the declaration themselves, even if an agent is acting on their behalf.)*

Signature:  Name: D. Tremble  
Position: Director Date: 23/10/18

Signature: \_\_\_\_\_ Name: \_\_\_\_\_  
Position: \_\_\_\_\_ Date: \_\_\_\_\_

## **F      Protection of information**

### **F1      Any confidential or national security info in your application?**

If there is any information in your application you think should be kept off the public register for confidentiality or national security reasons, please say what and why. [General guidance manual](#) chapter 8 advises on what may be excluded. *(Do not include any national security information in your application. Send it, plus the omitted information, to the Secretary of State or Welsh Ministers who will decide what, if anything, can be made public.)*

Document Reference \_\_\_\_\_

### **F2      Please note: data protection**

The information you give will be used by the Council to process your application. It will be placed on the relevant public register and used to monitor compliance with the permit conditions. We may also use and or disclose any of the information you give us in order to:

- consult with the public, public bodies and other organisations,
- carry out statistical analysis, research and development on environmental issues,
- provide public register information to enquirers,
- make sure you keep to the conditions of your permit and deal with any matters relating to your permit
- investigate possible breaches of environmental law and take any resulting action,
- prevent breaches of environmental law,
- offer you documents or services relating to environmental matters,
- respond to requests for information under the Freedom of Information Act 2000 and the Environmental Information Regulations 2004 (if the Data Protection Act allows)
- assess customer service satisfaction and improve our service.

We may pass on the information to agents/representatives who we ask to do any of these things on our behalf.

### **F3      Please note: it is an offence to provide false etc information**

It is an offence under regulation 38 of the EP Regulations, for the purpose of obtaining a permit (for yourself or anyone else), to:

- make a false statement which you know to be false or misleading in a material particular,
- recklessly make a statement which is false or misleading in a material particular
- intentionally to make a false entry in any record required to be kept under any environmental permit condition
- with intent to deceive, to forge or use a document issued or required for any purpose under any environmental permit condition.

If you make a false statement

- we may prosecute you, and
- if you are convicted, you are liable to a fine or imprisonment (or both).

# Door Manufacturing Floor Plans (2)

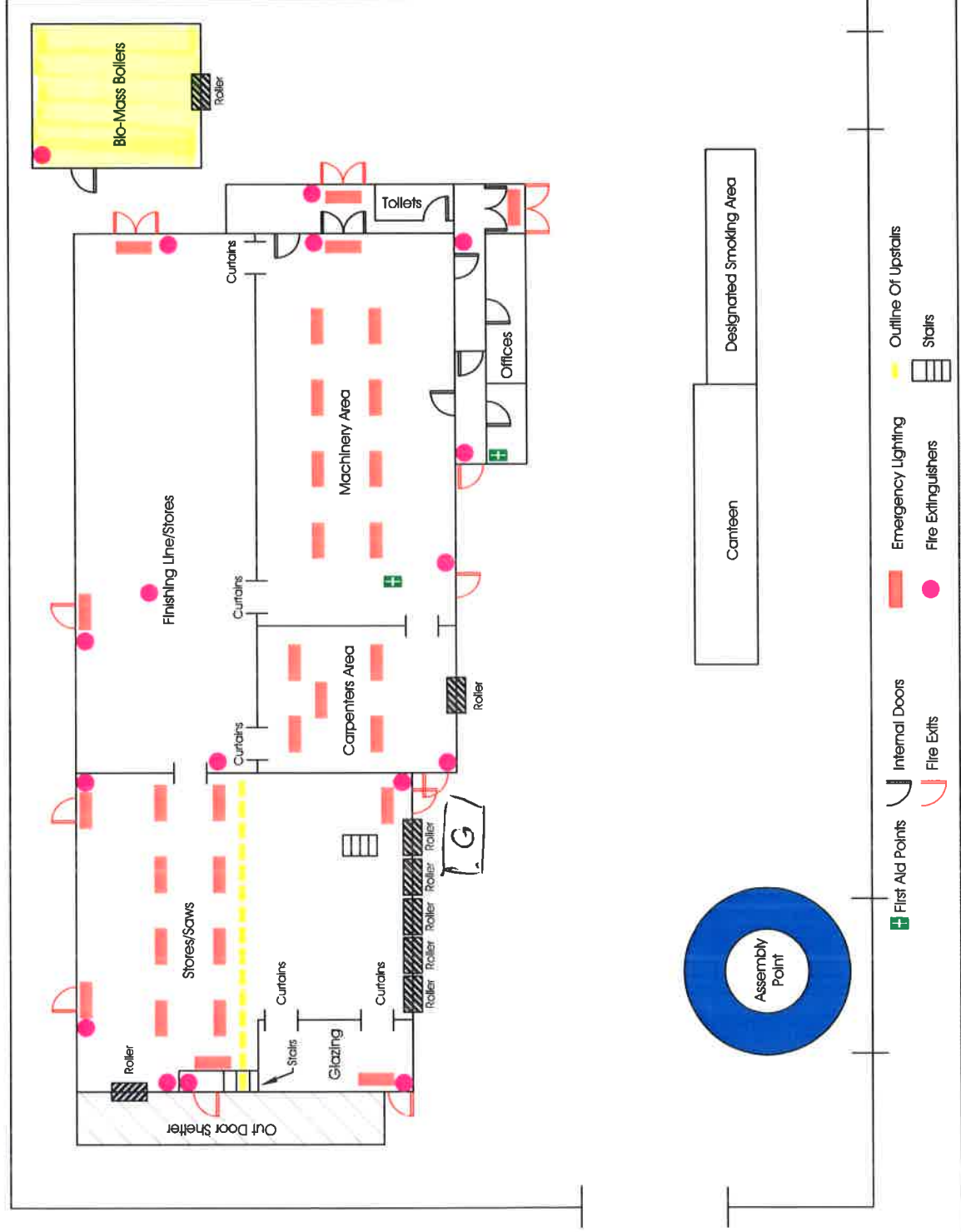



# Door Manufacturing Floor Plans

1

GE Door Manufacturing Ltd  
Forge Industrial Estate  
Maesteg  
CF34 0AZ  
01656 730070  
Info@gedoormanufacturing.co.uk

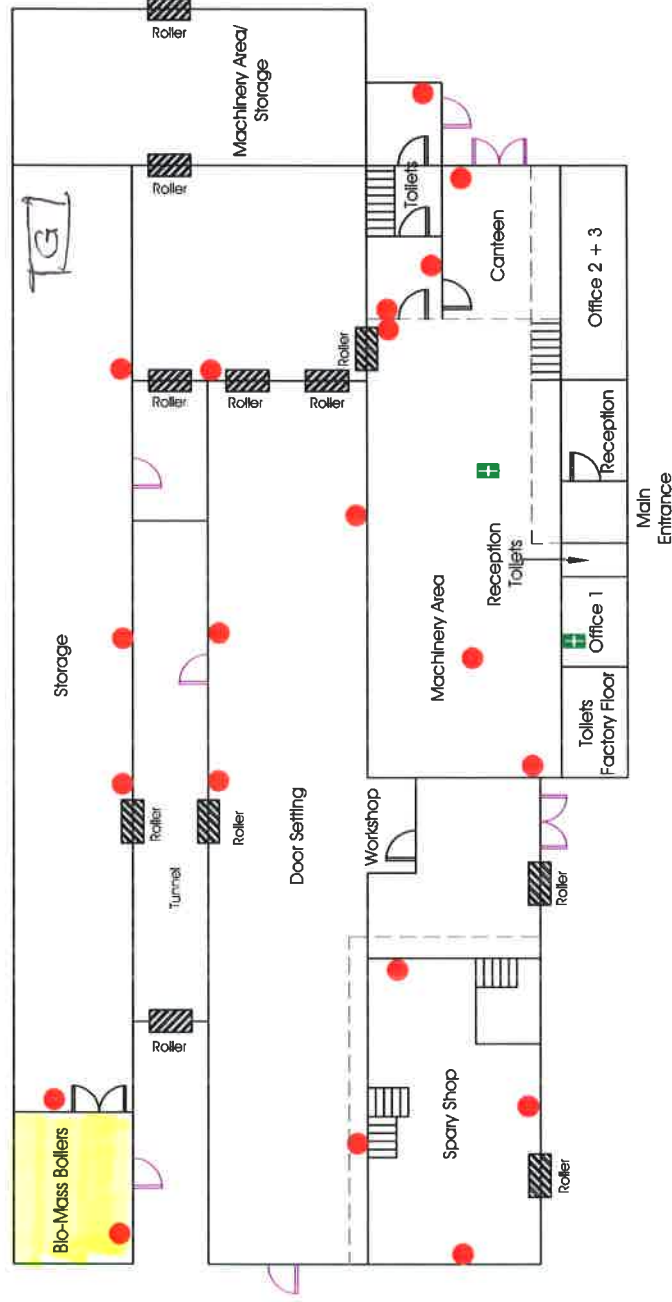

- Internal Doors
- Emergency Lighting
- Outline Of Upstairs
- First Aid Points
- Fire Exits
- Fire Extinguishers
- Stairs



